



**PRIOR**

## ML - SERIES

### SPECIFICATIONS

#### FAMILY RANGE

Code	Power	Dimensions
ML-5511-06	06W	Ø120*H145mm

#### PARAMETERS

Efficacy	110lm/W
CRI	>90
Adjustable	NO
Color Consistency	SDCM
Pf	0.9
Input Voltage	DC 48V
Operating Temp.	-10°C~40°C
Working Hours	50,000 Hrs

#### APPLICATION

- Modern Work spaces
- Institutions
- Retail Outlets
- Hotels
- High end Villa's

#### RELATED PARTS

Code	Track Rail
ML-5519	-Surface Mounted / Suspended
ML-5520	-Recessed Track Rail

#### DRAWING Unit:mm

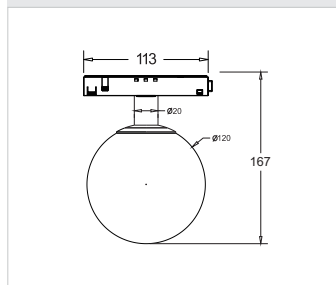

#### LED

SMD



CCT



Trio CCT  
2700K  
3000K  
4000K

#### Finish



SW SB GD

#### Material Description

Housing: Aluminum  
Diffuser: Glass

#### Beam Angle

175°



235°



#### Dimming Options



#### Photometric

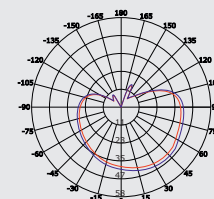

For detailed technical project cut sheet can be requested by our online portal at [www.priorled.com](http://www.priorled.com)

